

FT Fluid Temperature Sensing Valve



**YOUR KEY TO AUTOMATIC
FREEZE PROTECTION AND FLUID
TEMPERATURE CONTROL**



FT Automatic Freeze Protection And Fluid Temperature Control

The FT valve is the most economical way to protect outdoor pipelines and vessels from expensive freeze damage. A thermal actuator automatically opens the valve before the temperature of the fluid drops to the freezing point. By bleeding the fluid in the system only when the danger of a freeze-up exists, the valve delivers positive freeze protection with minimal waste. This intermittent operation provides substantial savings in water and sewer costs, making the FT valve an ideal, economical replacement for systems with manually operated block valves that are opened seasonally. The FT valve can also be used in most applications that involve automatic control of fluids, such as glycol, oil, light chemicals, etc.

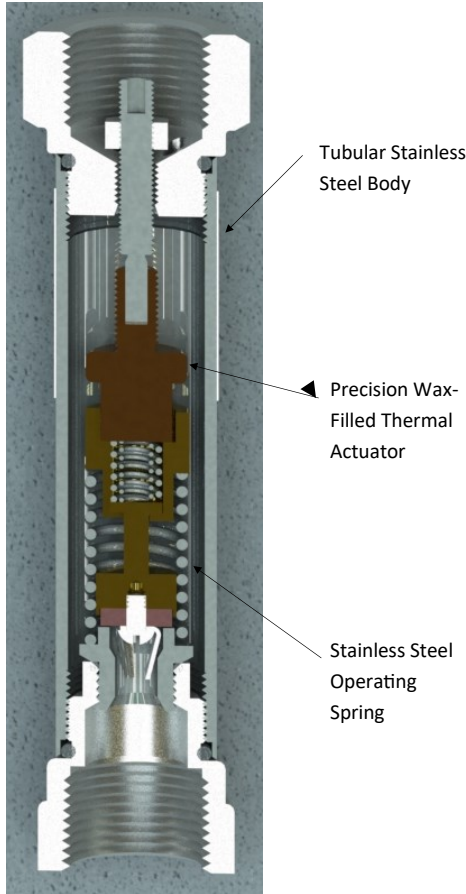

Typical Applications

- Exposed Water Lines— indoors or outside
- Fire Lines
- Sprinkler Systems
- Ship Supply Lines
- Safety Showers
- Tanks
- Condensate Returns
- Cooling Towers
- Air Scrubbers

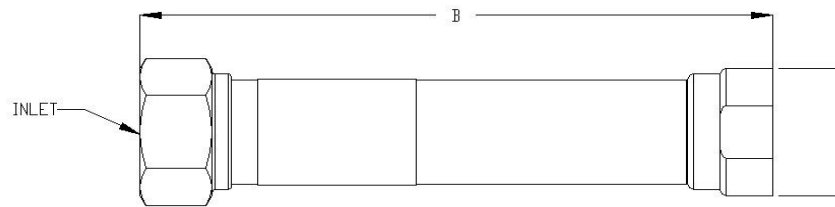

Size (NPT)	Valve Type	Available Set Point Temperature ¹	Available Ports	Max Operating Pressure-PSIG	C _v	Action	Body Material ²	Dimensions +/- .1/8"		Net Wt.
								A	B	
3/4"	FT	35° to 240°	1/4"	200	0.8	Direct	T	1.38"	5.00"	3/4#

1. Specify the desired full open set point temperature in 5°F increments
2. Tubular Stainless Steel